

FLIGHT SUMMARY REPORT

Flight Number: 93-011
Calendar/Julian Date: 28 October 1992 • 302
Sensor Package: Wild-Heerbrug RC-10
Area(s) Covered: Rosh Springs, Oklahoma

Investigator(s): Ferry Flight

Aircraft #: 708

SENSOR DATA

Accession #: 04495
Sensor ID #: 026
Sensor Type: RC-10
Focal Length: 12"
304.97 mm
Film Type: High Definition
Aerochrome IR
SO-131
Filtration: cc.20B
Spectral Band: 510-900 nm
f Stop: 4
Shutter Speed: 1/200
of Frames: 21
% Overlap: 60
Quality: Fair
Remarks: Severely underexposed
13 sec. offset between
camera and navigation data

Airborne Science and Applications Program

The Airborne Science and Applications Program (ASAP) is supported by three ER-2 high altitude Earth Resources Survey aircraft. These aircraft are operated by the High Altitude Missions Branch at NASA-Ames Research Center, Moffett Field, California. The ER-2s are used as readily deployable high altitude sensor platforms to collect remote sensing and *in situ* data on earth resources, celestial phenomena, atmospheric dynamics, and oceanic processes. Additionally, these aircraft are used for electronic sensor research and development and satellite investigative support.

The ER-2s are flown from various deployment sites in support of scientific research sponsored by NASA and other federal, state, university, and industry investigators. Data are collected from deployment sites in Kansas, Texas, Virginia, Florida, and Alaska. Cooperative international scientific projects have deployed the aircraft to sites in Great Britain, Australia, Chile, and Norway.

Photographic and digital imaging sensors are flown aboard the ER-2s in support of research objectives defined by the sponsoring investigators. High resolution mapping cameras and digital multispectral imaging sensors are utilized in a variety of configurations in the ER-2s' four pressurized experiment compartments. The following provides a description of the camera system(s) used for data collection during this flight.

Camera Systems

Various camera systems and films are used for photographic data collection. Film types include high definition color infrared, natural color, and black and white emulsions. Available photographic systems are as follows:

- Wild-Heerbrug RC-10 metric mapping camera
 - 9 x 9 inch film format
 - 6 inch focal length lens provides area coverage of 16 x 16 nautical miles from 65,000 feet
 - 12 inch focal length lens provides area coverage of 8 x 8 nautical miles from 65,000 feet
- Hycon HR-732 large scale mapping camera
 - 9 x 18 inch film format
 - 24 inch focal length lens provides area coverage of 4 x 8 nautical miles from 65,000 feet
- IRIS II Panoramic camera
 - 4.5 x 34.7 inch film format
 - 24 inch focal length lens
 - 90 degree field of view provides area coverage of 2 x 21.4 nautical miles from 65,000 feet

The U.S. Geological Survey's EROS Data Center at Sioux Falls, South Dakota serves as the archive and product distribution facility for NASA-Ames aircraft acquired photographic and digital imagery. For information regarding photography and digital data (including areas of coverage, products, and product costs) contact EROS Data Center, Customer Services, Sioux Falls, South Dakota 57198 (Telephone: (605) 594-6151).

Additional information regarding ER-2 acquired photographic and digital data is available through the Aircraft Data Facility at Ames Research Center. For specific information regarding flight documentation, sensor parameters, and areas of coverage contact the Aircraft Data Facility, NASA-Ames Research Center, Mail Stop 240-6, Moffett Field, California 94035-1000 (Telephone: (415) 604-6252).

**CAMERA FLIGHT LINE DATA
FLIGHT NO. 93-011**

Accession # 04495
Sensor # 026

| Check Points | Frame Numbers | Time (GMT-hr, min, sec) | | Altitude, MSL feet/meters | Cloud Cover/Remarks |
|--------------|---------------|-------------------------|----------|------------------------------|---------------------|
| | | START | END | | |
| A - B | 2983-3004 | 18:56:18 | 19:06:02 | 65000/19800 | Clear |

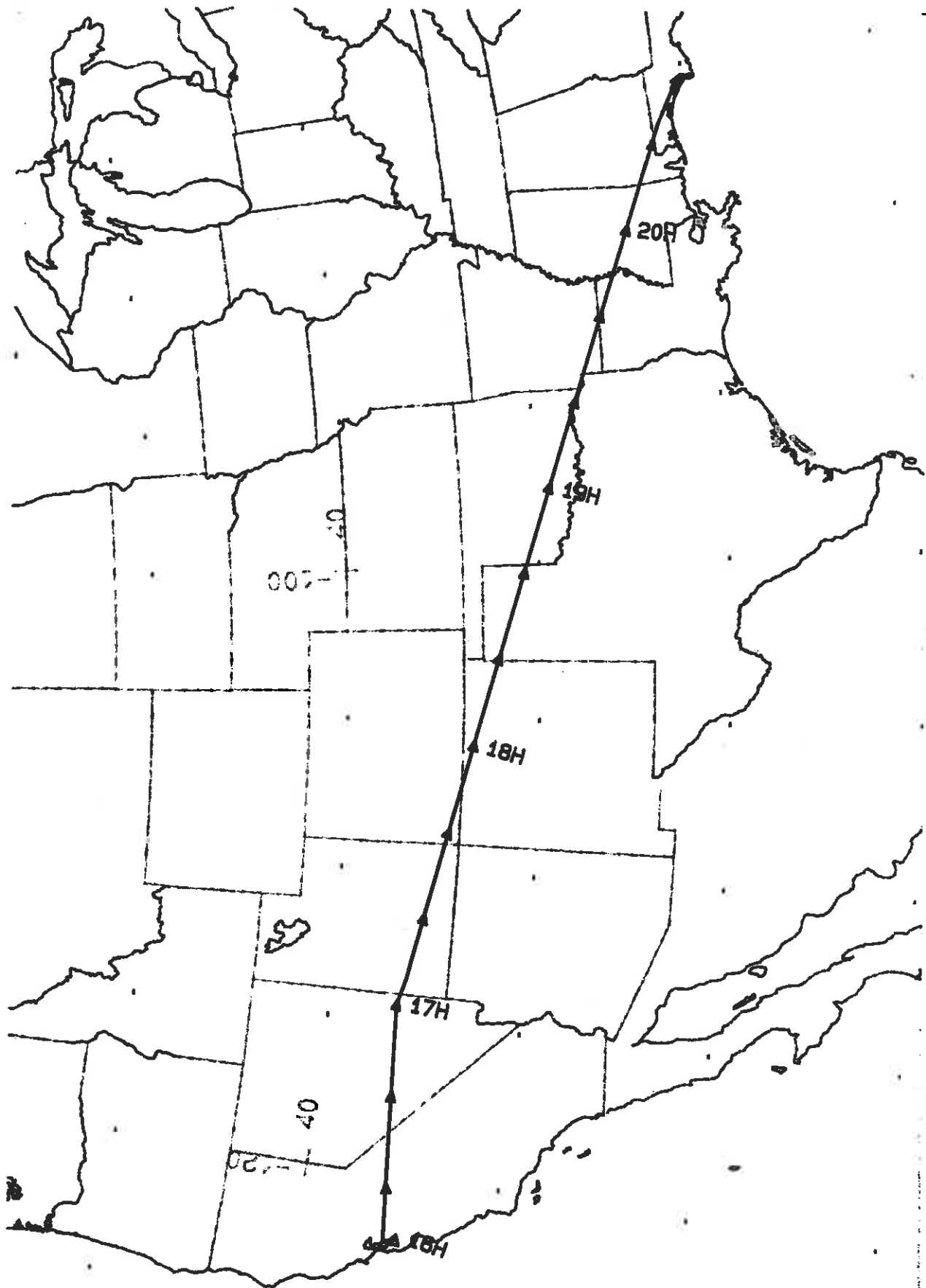

FLIGHT 93-011 28 OCTOBER 1992 A/C 706 TYNDALL AFB FERRY RC-10

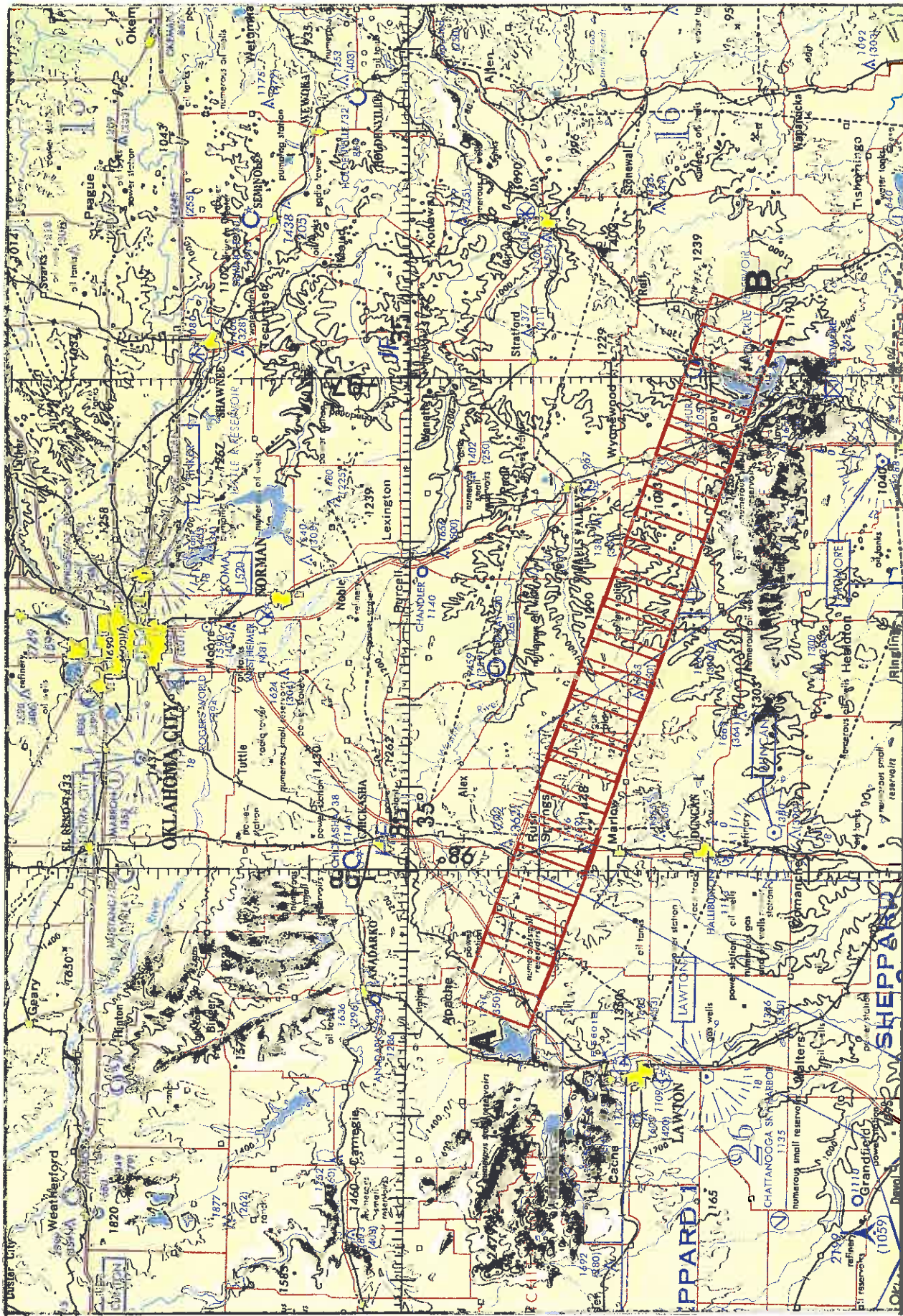

FLIGHT 33-011

28 OCTOBER 1992

A/C 708

PL-10

Accession #04193

UNC 6-10